

2880 Slack Reducing Coupling



→ New Product

THE BEAST

This **monster-of-a-coupling** has a sleek design but was specifically engineered to tame tropical applications with GTW capacities of **up to 85 tons**. Made with our work-hardening Premalloy, for unsurpassed wear resistance. Easy to operate and you can get it with our new EL option.

ORDERING INFORMATION

Coupling Only:

- 2880 & 271 Thimble
- 2880EL: 2880 with Extended Life latch direct-inject latch lubrication ports

Standard Installation Kit:

- 2880A: 2880 Coupling, **511 Bolt Kit**, 282 Air Chamber, 767 Air Chamber Adapter Bracket, 271 Thimble
- 2880ELA: 2880EL Coupling, **511 Bolt Kit**, 282 Air Chamber, 767 Air Chamber Adapter Bracket, 271 Thimble

Optional Accessories:

- **Thimbles (page 76):** 271B (4 3/8 in. / 111 mm), 271C (5 1/2 in. / 140 mm)
- **Wear Gage 14038 (page 75):** To determine hook wear limits
- **Latch Gage 14026 (page 75):** To determine latch gap limit
- **Bolt Kit 511 (page 77):** Bolt Kit 511 uses coarse threaded L9 Grade bolts. Bolts (6) 3 1/2 in., Locknuts (6)

SPECIFICATIONS

Maximum Gross Trailer Weight:	150,000 lbs.	(68,038 kg)
Maximum Tongue Weight:	30,000 lbs.	(13,607 kg)
Ultimate Latch Capacity:	60,000 lbs.	(27,215 kg)
Maximum Eye X-Section:	1 13/16 in.	(46 mm)
Minimum Eye Opening:	3 in.	(76 mm)
Unit Weight:	42.1 lbs.	(19.1 kg)

STANDARD INSTALLATION DRAWING

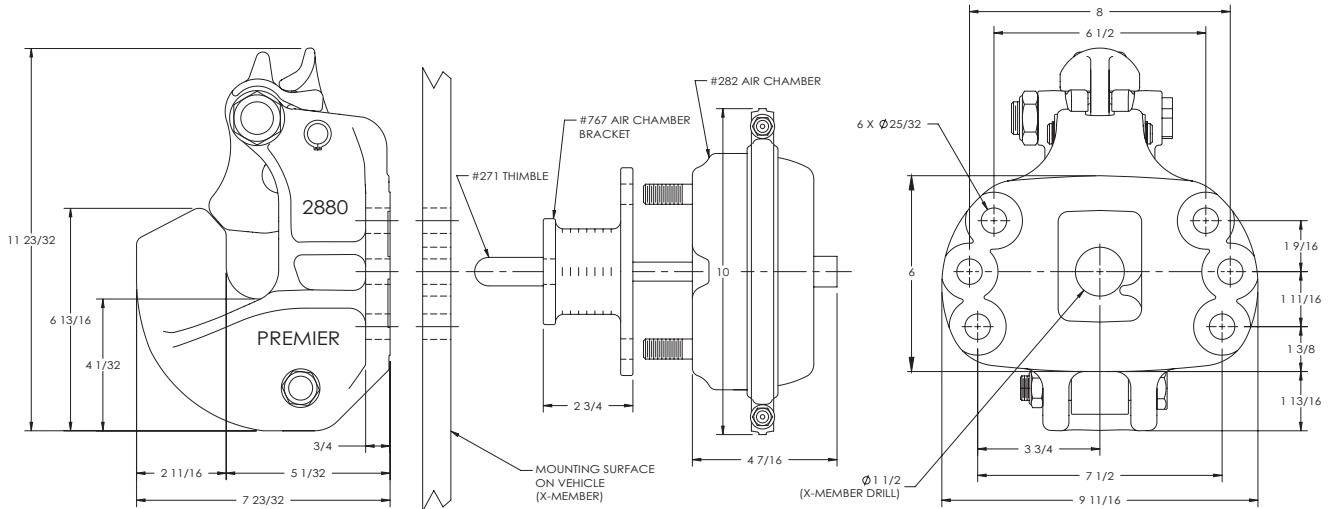

Pushrod length should be 3 3/4 in. (95 mm) plus thickness of mounting structure for standard installations as illustrated.

REPLACEMENT PART INFORMATION

2000PK Parts Kit Includes:

- | | |
|----------------------|----------------|
| 44-62: Snap Ring (2) | 2073A: Spring |
| 297: Locknut | 2073B: Bushing |
| 373B: Spacer | *266: Spring |
| 388: Pin | *271: Thimble |
| 2071: Bolt | *274A: Locknut |
| 2072: Latch | *279: Shoe |
| 2072A: Spring | *374: Bolt |
| 2072B: Bushing | |
| 2073: Latch Lock | |

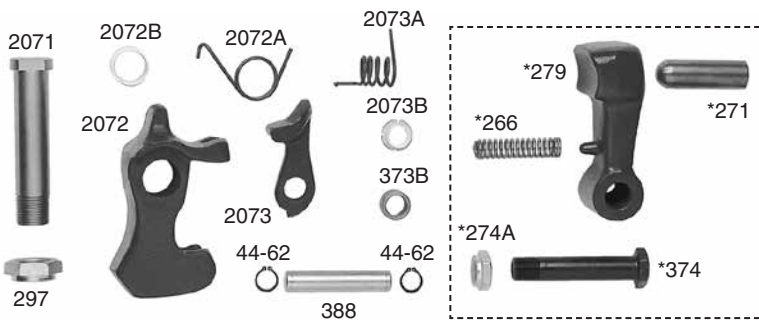

*Not included in parts kit, available as 279PK Parts Kit.

IMPORTANT GUIDELINES that apply to all Premier Slack Reducing Couplings

- Do not weld on any coupling assembly
- Always use Grade-8 fasteners properly torqued
- Do not apply lubricants to the coupling hook
- Air service chamber must be Type-24 or Type-30 with 90-120 PSI air supply
- Clean & inspect coupling for damage & excessive wear prior to each and every use
- Lubricate all coupling components at a minimum of 90 day intervals
- Do not bind-up (Jackknife) any application as stresses can cause damage to products or components, resulting in failure and detachment of the trailer while in use

